

Technical Data Overview

Nominal sizes

Inch: 1" / 1.5" / 2" / 2.5" / 3" / 4"
DIN: 25 / 40 / 50 / 65 / 80 / 100

Materials

Inox parts in contact with product: AISI 316L (1.4404 / 1.4435)
Other inox parts: AISI 304 (1.4301)
O-ring seals: EPDM, FKM (Viton®), FEP,
other grades upon request
Shutter: Dyneon™ TFM1600

Surfaces

In contact with product: Ra ≤ 32µin (Ra ≤ 0.8µm)

Temperature

Operating temperature: 230°F (110°C)
Short-term: 284°F (140°C)
– optionally up to 392°F (200°C)

Operating pressure

Pressure behind arc: 145 psi (10 bar)
– optionally up to 290.1 psi (20 bar)
Pressure against arc: 43.5 psi (3 bar)

Version

2-way

Actuator

Electro-pneumatic control unit consisting of:
• Pneumatic actuator 0°-90°
• Positioner Positurn 4-20mA (0-10V), 24V DC, IP65

Valve connection

Clamp connection: Tri-Clamp
Welded ends: Inch, DIN
Male ends: DIN 11851

Further options / Certificates

- Linearization insert - mechanical adaptation of control characteristic
- Electric actuator with MOD positioner 4-20mA (0-10V), 220-240V, 50/60Hz / IP65 / 0°-90° (110V AC-version upon request)
- Shutter material; alternatively glass-fiber reinforced Teflon (GL25), Tecapeek®
- Heated version
- Leakage control of moving O-ring seal / steam barrier with ball-bearing supported selector shaft
- EHEDG certified CIP/SIP capability (hygienic design)
- 3-A 51-01 and FDA compliance
- CRN

CONTROL SHUTTER VALVES

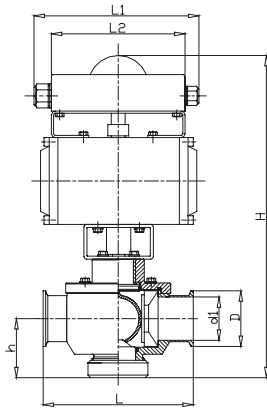
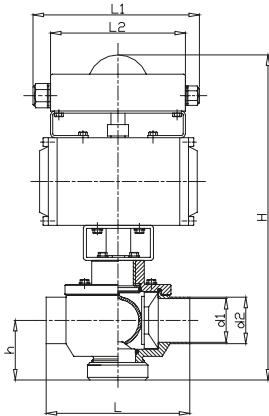

Inch

2-way control shutter valve, pneumatic (air/air - air/spring), welded ends

VALVE SIZE inch (mm)	Type	Ø d1	Ø d2	H	h	L	L1	L2
1.00 (25.4)	25C52Aep21	0.87 (22.1)	1.00 (25.4)	13.03 (331)	1.97 (50)	4.33 (110)	7.80 (198)	6.06 (154)
1.50 (38.1)	38C52Aep21	1.37 (34.8)	1.50 (38.1)	14.33 (364)	2.56 (65)	5.51 (140)	7.80 (198)	6.06 (154)
2.00 (50.8)	51C52Aep21	1.87 (47.5)	2.00 (50.8)	14.57 (370)	2.76 (70)	6.46 (164)	7.80 (198)	6.06 (154)
2.50 (63.5)	63C52Aep21	2.37 (60.2)	2.50 (63.5)	16.26 (413)	2.95 (75)	8.27 (210)	7.80 (198)	6.06 (154)
3.00 (76.2)	76C52Aep21	2.87 (72.9)	3.00 (76.2)	16.89 (429)	3.15 (80)	8.66 (220)	7.80 (198)	6.06 (154)
4.00 (101.6)	102C52Aep21	3.83 (97.4)	4.00 (101.6)	18.31 (465)	4.33 (110)	12.20 (310)	7.80 (198)	6.06 (154)

Electro-pneumatic control unit consisting of:

- Pneumatic actuator 0°-90°
- Positioner Positurn 4-20mA (0-10V), 24V DC, IP65

2-way control shutter valve, pneumatic (air/air - air/spring), TC-clamp

VALVE SIZE inch (mm)	Type	Ø d1	Ø D	H	h	L	L1	L2
1.00 (25.4)	25C520Aep21	0.87 (22.1)	1.99 (50.5)	13.03 (331)	1.97 (50)	5.31 (135)	7.80 (198)	6.06 (154)
1.50 (38.1)	38C520Aep21	1.37 (34.8)	1.99 (50.5)	14.33 (364)	2.56 (65)	6.50 (165)	7.80 (198)	6.06 (154)
2.00 (50.8)	51C520Aep21	1.87 (47.5)	2.52 (64.0)	14.57 (370)	2.76 (70)	7.44 (189)	7.80 (198)	6.06 (154)
2.50 (63.5)	63C520Aep21	2.37 (60.2)	3.05 (77.5)	16.26 (413)	2.95 (75)	9.25 (235)	7.80 (198)	6.06 (154)
3.00 (76.2)	76C520Aep21	2.87 (72.9)	3.58 (91.0)	16.89 (429)	3.15 (80)	9.65 (245)	7.80 (198)	6.06 (154)
4.00 (101.6)	102C520Aep21	3.83 (97.4)	4.68 (119.0)	18.31 (465)	4.33 (110)	13.19 (335)	7.80 (198)	6.06 (154)

Electro-pneumatic control unit consisting of:

- Pneumatic actuator 0°-90°
- Positioner Positurn 4-20mA (0-10V), 24V DC, IP65