

LIAG®

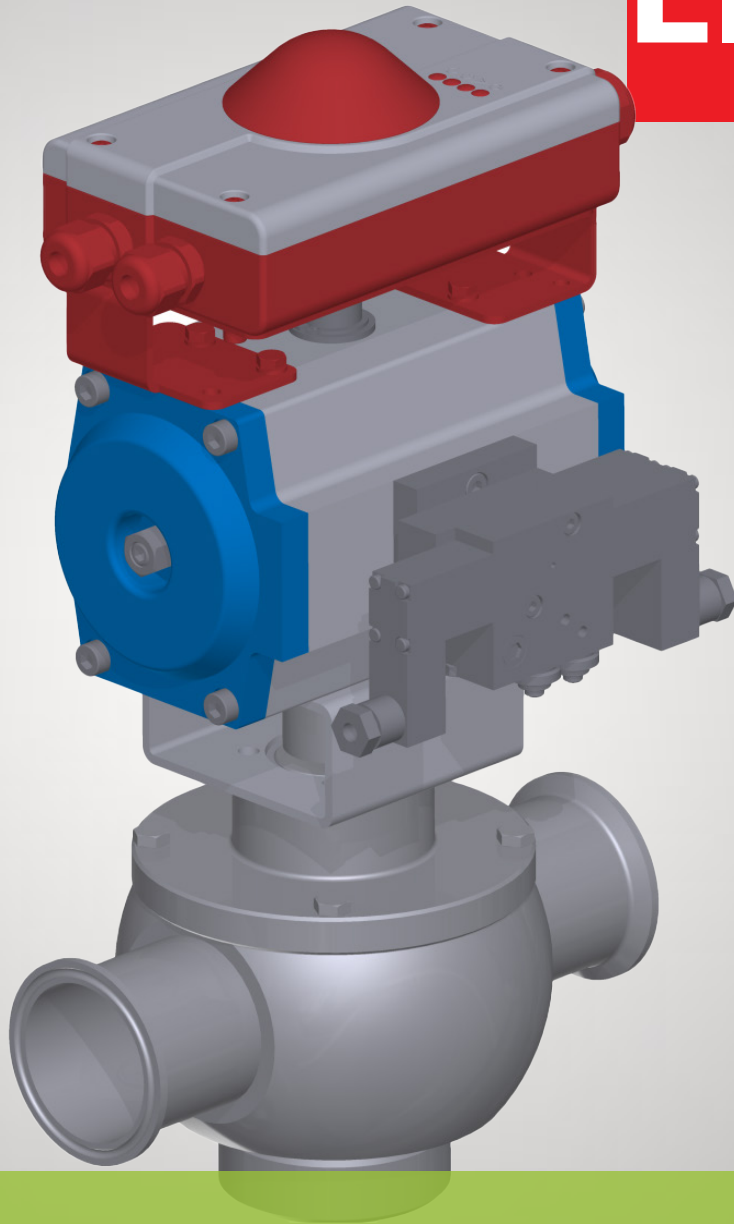

LAUFER
Valve Technology Inc.

2-Way Control Shutter Valve

2-Way Control Arc Valve

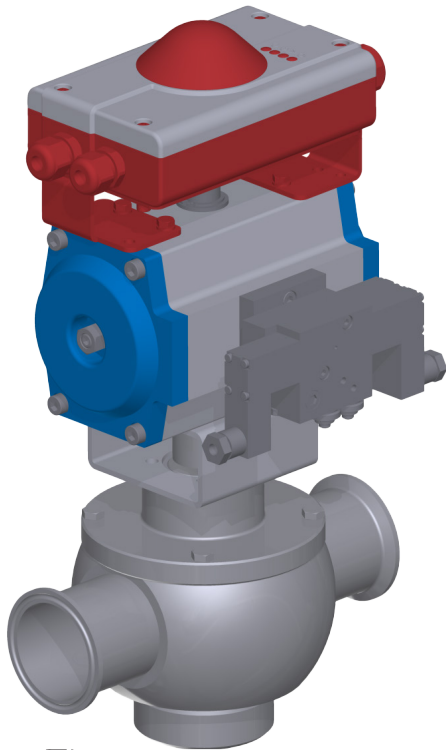

3
51-01

Ideal for controlling sensitive media containing solid particles

On account of their favorable flow characteristic LIAG® free flow shutter valves are particularly suited for proportioning viscous and pasty products. Depending on the product to be proportioned LIAG® control shutter valves can be delivered with various shutter qualities and linearization inserts. Control is performed via a standard 4-20mA (0-10V) electropneumatic actuator. The control characteristic / rate of flow or the control range can be adapted to customer requirements.

Features

- No dead pockets
- CIP/SIP capability
- Product-saving proportioning
- No product remainders or sticking of solid particles
- Full linearization option of control characteristic
- Minimum number of components and wearing parts
- Can be completely dismantled even when welded in place
- 3-A 51-01 and FDA compliance
- Identical wearing and spare parts as shutter valves
- CRN

Flow characteristic LIAG® control arc valve

Kv-value [%]

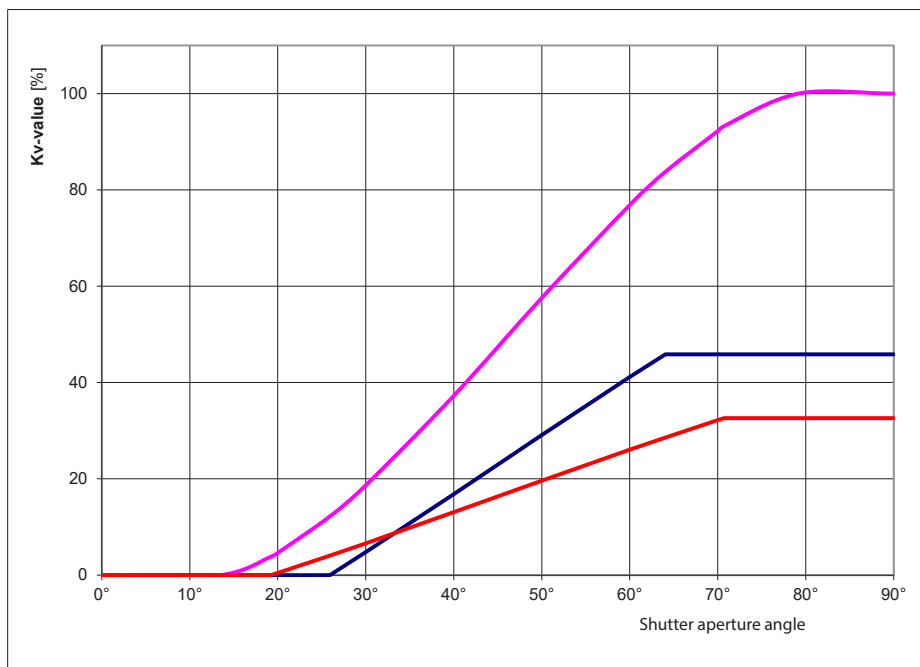

Outlet: Standard "full bore" ○

Outlet: Linearization insert "square" □

Outlet: Linearization insert "rectangle" ▭

Technical Data Overview

Nominal sizes

Inch: 1" / 1.5" / 2" / 2.5" / 3" / 4"
DIN: 25 / 40 / 50 / 65 / 80 / 100

Materials

Inox parts in contact with product: AISI 316L (1.4404 / 1.4435)
Other inox parts: AISI 304 (1.4301)
O-ring seals: EPDM, FPM (Viton®), FEP, other grades upon request
Shutter: Dyneon™TFM1600

Surfaces

In contact with product: $Ra \leq 0,8 \mu\text{m}$ ($Ra \leq 32 \mu\text{in}$)

Temperature

Operating temperature: 230°F (110°C)
Short-term: 284°F (140°C)
- optionally up to 392°F (200°C)

Operating pressure

Pressure behind arc: 145 psi (10 bar)
- optionally up to 290,1 psi (20 bar)
Pressure against arc: 43,5 psi (3 bar)

Versions

2-way

Actuator

Electro-pneumatic control unit consisting of:
• Pneumatic actuator 0° - 90°
• Positioner Positurn 4-20mA (0-10V), 24V DC, IP65

Valve connection

Clamp connection: Tri-Clamp
Welded ends: Inch, DIN
Male ends: DIN 11851

Further options / Certificates

- Linearization insert - mechanical adaptation of control characteristic
- Electric actuator with MOD positioner 4-20mA (0-10V), 220-240V, 50/60Hz / IP65 / 0°-90° (110V AC-version upon request)
- Shutter material; alternatively: Tecapeek®, PTFE+15% Peek
- Heated version
- Leakage control of moving O-ring seal / steam barrier with ball-bearing supported selector shaft
- 3-A 51-01 and FDA compliance
- CRN

LAUFER Valve Technology Inc., 2300 Walnut Ave, Suite Q-R, Signal Hill, CA 90755

T: +1.562.232.4777 - sales@laufer-valve.com - www.laufer-valve.com

