

CONTROL SHUTTER VALVES

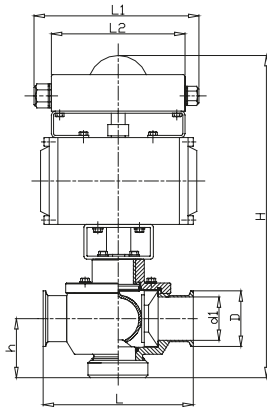
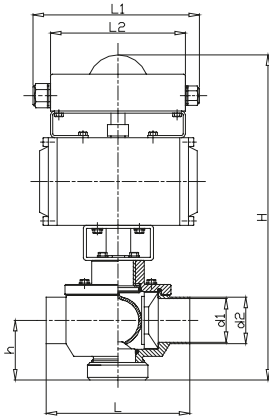

Inch

2-way control shutter valve, pneumatic (air/air - air/spring), welded ends

VALVE SIZE inch (mm)	Type	Ø d1	Ø d2	H	h	L	L1	L2
1.00 (25.4)	25C52Aep21	0.87 (22.1)	1.00 (25.4)	13.03 (331)	1.97 (50)	4.33 (110)	7.80 (198)	6.06 (154)
1.50 (38.1)	38C52Aep21	1.37 (34.8)	1.50 (38.1)	14.33 (364)	2.56 (65)	5.51 (140)	7.80 (198)	6.06 (154)
2.00 (50.8)	51C52Aep21	1.87 (47.5)	2.00 (50.8)	14.57 (370)	2.76 (70)	6.46 (164)	7.80 (198)	6.06 (154)
2.50 (63.5)	63C52Aep21	2.37 (60.2)	2.50 (63.5)	16.26 (413)	2.95 (75)	8.27 (210)	7.80 (198)	6.06 (154)
3.00 (76.2)	76C52Aep21	2.87 (72.9)	3.00 (76.2)	16.89 (429)	3.15 (80)	8.66 (220)	7.80 (198)	6.06 (154)
4.00 (101.6)	102C52Aep21	3.83 (97.4)	4.00 (101.6)	18.31 (465)	4.33 (110)	12.20 (310)	7.80 (198)	6.06 (154)

Electro-pneumatic control unit consisting of:

- Pneumatic actuator 0°-90°
- Positioner Positurn 4-20mA (0-10V), 24V DC, IP65

2-way control shutter valve, pneumatic (air/air - air/spring), TC-clamp

VALVE SIZE inch (mm)	Type	Ø d1	Ø D	H	h	L	L1	L2
1.00 (25.4)	25C520Aep21	0.87 (22.1)	1.99 (50.5)	13.03 (331)	1.97 (50)	5.31 (135)	7.80 (198)	6.06 (154)
1.50 (38.1)	38C520Aep21	1.37 (34.8)	1.99 (50.5)	14.33 (364)	2.56 (65)	6.50 (165)	7.80 (198)	6.06 (154)
2.00 (50.8)	51C520Aep21	1.87 (47.5)	2.52 (64.0)	14.57 (370)	2.76 (70)	7.44 (189)	7.80 (198)	6.06 (154)
2.50 (63.5)	63C520Aep21	2.37 (60.2)	3.05 (77.5)	16.26 (413)	2.95 (75)	9.25 (235)	7.80 (198)	6.06 (154)
3.00 (76.2)	76C520Aep21	2.87 (72.9)	3.58 (91.0)	16.89 (429)	3.15 (80)	9.65 (245)	7.80 (198)	6.06 (154)
4.00 (101.6)	102C520Aep21	3.83 (97.4)	4.68 (119.0)	18.31 (465)	4.33 (110)	13.19 (335)	7.80 (198)	6.06 (154)

Electro-pneumatic control unit consisting of:

- Pneumatic actuator 0°-90°
- Positioner Positurn 4-20mA (0-10V), 24V DC, IP65